

35 LB. SIZE ORIGINAL CONTAINER  
50:1 RATIO

REPAIR PARTS

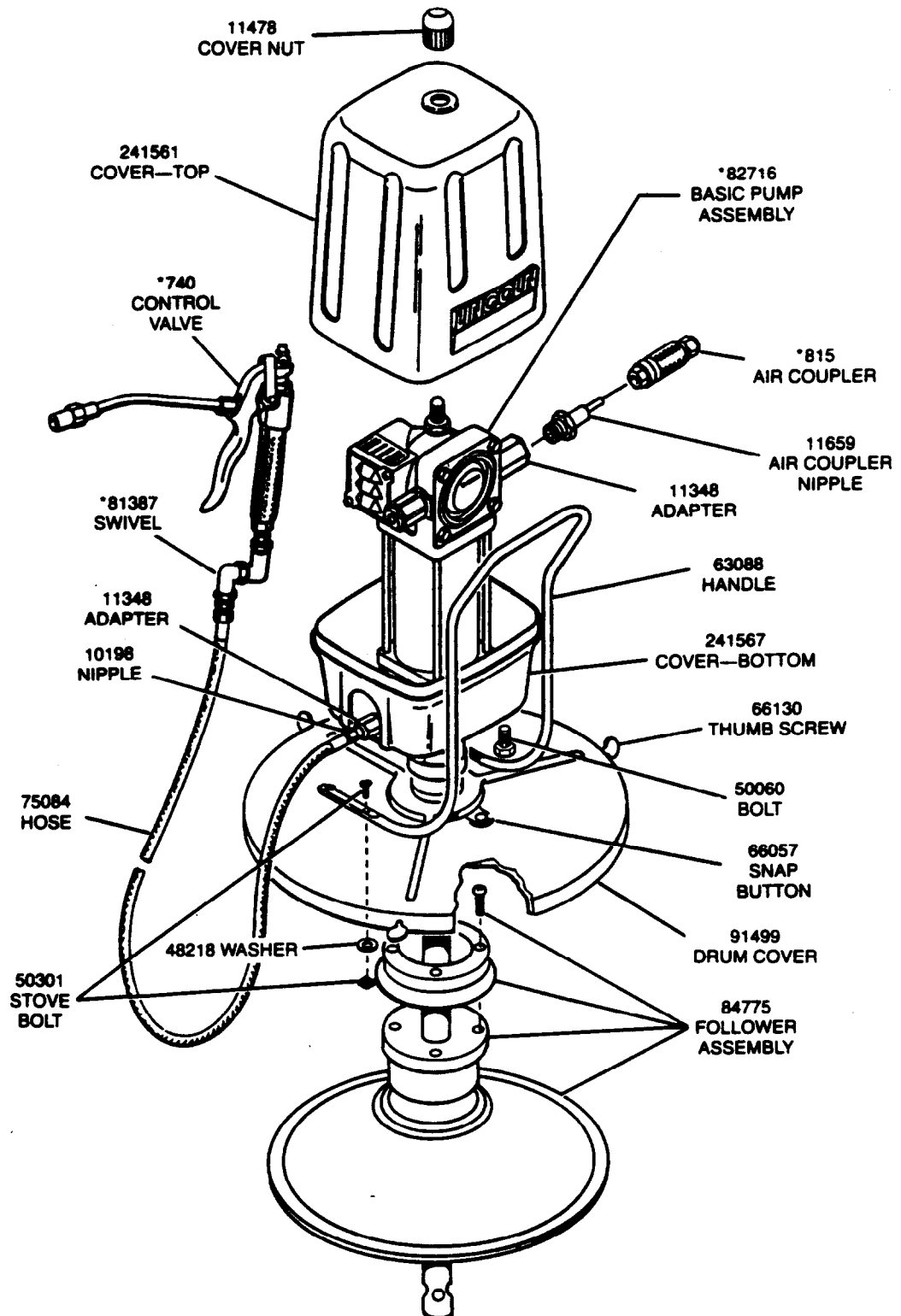

**\*REFER TO SEPARATE INSTRUCTIONS:**

740 Control Valve ~~Section A5, Page 52 Series~~  
 815 Air Coupler Section A5, Page 52 Series  
 81387 Swivel Section A5, Page 52 Series  
 82716 Basic Pump Section A5, Page 54 Series

*F3-2*

**COMPONENT PARTS**

| Part  | Qty. | Description        | Part   | Qty. | Description         |
|-------|------|--------------------|--------|------|---------------------|
| 740   | 1    | Control valve      | 66057  | 1    | Snap button         |
| 815   | 1    | Air coupler        | 66130  | 3    | Thumb screw         |
| 10198 | 1    | Nipple             | 75084  | 1    | Lubricant hose      |
| 11348 | 2    | Adapter            | 81387  | 1    | Universal swivel    |
| 11478 | 1    | Cover nut          | 82716  | 1    | Basic pump assembly |
| 11659 | 1    | Air coupler nipple | 91499  | 1    | Drum cover          |
| 48218 | 4    | Washer             | 84775  | 1    | Follower assembly   |
| 50060 | 4    | Bolt               | 241561 | 1    | Cover—top           |
| 50301 | 4    | Stove bolt and nut | 241567 | 1    | Cover—bottom        |
| 63088 | 1    | Handle             |        |      |                     |

**RETAIN THIS INFORMATION FOR FUTURE REFERENCE**

When ordering replacement parts, list: Part Number, Description, Model Number, and Series Letter.

LINCOLN provides a Distributor Network that stocks equipment and replacement parts.